

Holland America 16 Day Viking Passage

This is your invitation to join **Baldwin and Lucy Verstraete** on this amazing Cruise



Day	Date	Port	Arrive	Depart
0	29 Aug 2012	Amsterdam, The Netherlands		05:00 PM
1	30 Aug 2012	At Sea		
2	31 Aug 2012	Stavanger, Norway	08:00 AM	05:00 PM
3	01 Sep 2012	Flam, Norway ^{TR}	08:00 AM	06:00 PM
3	01 Sep 2012	Scenic cruising Sognefjord ^{CO}		
4	02 Sep 2012	Lerwick, Shetland Islands	10:00 AM	05:00 PM
5	03 Sep 2012	At Sea		
6	04 Sep 2012	Reykjavik, Iceland ^{ON}	01:00 PM	
7	05 Sep 2012	Reykjavik, Iceland		05:00 PM
8	06 Sep 2012	At Sea		
9	07 Sep 2012	Cruising Prince Christian Sund ^{CO}		
10	08 Sep 2012	Nanortalik, Greenland ^{TR}	08:00 AM	01:00 PM
10	08 Sep 2012	Cruising Julianehabsfjord ^{CO}		
11	09 Sep 2012	At Sea		
12	10 Sep 2012	St. John's, Newfoundland, CA	10:00 AM	08:00 PM
13	11 Sep 2012	At Sea		
14	12 Sep 2012	Halifax, Nova Scotia, CA	08:00 AM	06:00 PM
15	13 Sep 2012	At Sea		
16	14 Sep 2012	New York, New York, US	07:00 AM	

^{CO} CRUISING ONLY
^{ON} OVERNIGHT
^{TR} TENDER REQUIRED

ms Eurodam

Ship's Registry: the Netherlands

Passenger capacity: 2,104

Crew members: 929

Gross tonnage: 86,700grt

Length: 936 feet

Beam: 105.8

Maximum speed: 23.9 knots



Launching her maiden voyage in July of 2008, the *ms Eurodam* marks Holland America Line's new Signature-class ships. The *ms Eurodam* furthers the evolution of our sophisticated mid-sized ships with 11 passenger decks, a new topside Pan-Asian restaurant and lounge surrounded by panoramic views, an Explorer's Lounge bar, a new Italian restaurant adjacent to the Lido, elegant luxury jewelry boutique, new atrium bar area, an enhanced and reconfigured show lounge and a new photographic and imaging center. On the technical side, the *ms Eurodam* features the latest state-of-the-art navigation and safety systems. The ship is powered by six diesel generators and propelled by the latest Azipod® propulsion technology.

Following in the Holland America Line tradition, the *ms Eurodam* features an exquisite art collection based on the theme, "The Dutch Golden Age — An Inexhaustible Tradition". Highlighting works by Dutch masters and contemporary artists, some of the pieces featured will include 17th-century watercolor maps by famed cartographer Johannes Vingboons, photo-realistic oil paintings by artist Jan van 't Hoff and *The Nightwatch, Two Minutes Later*, a contemporary reinterpretation of Rembrandt's famous painting.

FEATURES:

Canaletto Restaurant: New Italian restaurant

Tamarind Restaurant and Silk Den Lounge: our new Pan-Asian restaurant and lounge with panoramic views of the ocean and Lido Pool area.

Cabanas: Introducing our new private cabanas which are available to reserve by the day or by the cruise. Available on two decks, they are tastefully decorated, filled with amenities and provide an exquisite poolside retreat.

The Retreat: Your own private oasis located high above the rest. Our exclusive Retreat cabanas are the ultimate place to relax surrounded by healthy refreshments and luxurious amenities.

Spa Suites and Staterooms: Relaxation...privacy...serenity. These are the hallmarks of the *ms Eurodam's* spacious new Spa Suites and Staterooms, located on the Panorama and Observation decks include special spa amenities.

ADDITIONAL FEATURES TO THE MS EURODAM

Digital Workshop, powered by Windows® Guests will be able to “show and tell” their vacation memories, learning how to share all their digital memories through email, blogging and social networking — so friends and family can see where they've been cruising even before they return home. Free workshops taught by Microsoft-trained "techsperts" make it easy and fun, even for novices.

Culinary Arts Center, presented by *Food & Wine* magazine: our state-of-the-art demonstration kitchen for gourmet presentations, tasting events and intimate cooking classes.

Greenhouse Spa & Salon: features heavenly beauty and wellness rituals. Enjoy a facial, hot stone massage, steam in a thermal suite and have your hair and nails done for a special evening.

Rembrandt Dining Room: features impeccable service and an extensive wine list. Five-course menus include continental cuisine, vegetarian and low-carb options.

Pinnacle Grill: This intimate venue offers an elegant, sophisticated dining experience. Featuring premium Sterling Silver Beef®, inspired seafood dishes and many select wines rated "Excellent" by *Wine Spectator* — as well as distinctive Bvlgari® china, Riedel stemware and Frette® linens.

Lido Restaurant: offers a relaxed ambiance for all three meals and features a variety of fresh, cooked-to-order specialties.

Explorations Café, powered by *The New York Times*: a comfortable, coffee house environment where you can browse through an extensive library, surf the Internet and check email or simply read the morning paper.

The Mainstage Show Lounge: features talented vocalists, dancers, illusionists, comedians and variety acts.

Crow's Nest: offers sweeping 270° views during the day, and a hip, fashionable nightclub each evening.

The Loft: designed exclusively for teens to have fun, socialize and hang out with people their own age, includes our new video editing facility for teens.

CABINS:

Superior Verandah Suites Category: SS, SY, SZ, SU

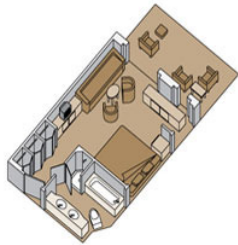

2 lower beds convertible to 1 queen-size bed, bathroom with dual sink vanity, full-size whirlpool bath, shower and additional shower stall, large sitting area, private verandah, 1 sofa bed for 1 person, floor-to-ceiling windows. Approximately 273–456 sq. ft. including verandah.

Include all the stateroom amenities, plus:

- A variety of firm, medium and soft pillows
- No-host mini-bar for easy entertaining
- Personalized cruise stationery
- Oversized bath towels
- One-touch telephone concierge service
- Fresh flowers
- Complimentary DVD library

Verandah Oceanview Staterooms Categories V, VA, VB, VC, VD, VE, VF, VH, VQ, VT Approx. 254 sq. ft.



2 lower beds convertible to 1 queen-size bed, bathtub & shower, sitting area, private verandah, floor-to-ceiling windows

Oceanview Staterooms All GG-, H- and HH-category staterooms have fully obstructed views. Categories C, CA, D, DD, E, F, G, GG, H, HH Approx. 185 sq. ft.



2 lower beds convertible to 1 queen-size bed, shower. All G-category staterooms have partially obstructed views

Complete ship details, terms and conditions can be found at www.hollandamerica.com.

Fuel Supplement Notification

The Fuel Supplement has been suspended for this sailing however, Holland America reserves the right to re-instate a fuel supplement for all guests should the price of light sweet crude oil according to the NYMEX (New York Mercantile Exchange Index) increase above \$70 USD per barrel.

Verstraete Travel & Cruises

300 – 14845 Yonge Street, Aurora, ON L4G 6H8

Office 1.800.565.9267, 416.969.8100 Fax 905.727.8113

email: aurora@verstraete.com

Website: verstraetetravel.com